

V43 Points

| PART ID | DESCRIPTION* | A LENGTH mm / in | B BIT WIDTH mm / in | C BIT THICKNESS mm / in | D WIDTH AT EARS mm / in | WEIGHT kg / lb |
|----------|--------------------------------|------------------------|------------------------------|----------------------------------|----------------------------------|-------------------|
| V43AD | Abrasion Penetration NCL | 308 / 12.12 | 82 / 3.21 | 33 / 1.28 | 137 / 5.39 | 18 / 39 |
| V43ADH | Abrasion Penetration Heavy NCL | 308 / 12.12 | 82 / 3.21 | 33 / 1.28 | 137 / 5.39 | 24 / 52 |
| V43AR | Abrasion Rock NCL | 297 / 11.71 | 165 / 6.50 | 46 / 1.80 | 137 / 5.39 | 22 / 48 |
| V43ARH | Abrasion Rock Heavy NCL | 297 / 11.71 | 165 / 6.50 | 51 / 2.00 | 137 / 5.39 | 25 / 56 |
| V43RYL | Standard Rock CL | 254 / 10.00 | 127 / 5.00 | 29 / 1.16 | 137 / 5.39 | 12 / 27 |
| V43S9F | Flare CL | 312 / 12.30 | 229 / 9.00 | 14 / 0.56 | 137 / 5.39 | 17 / 39 |
| V43SDX | Chisel Heavy CL | 293 / 11.53 | 83 / 3.25 | 14 / 0.57 | 137 / 5.39 | 14 / 30 |
| V43SHV | Penetration Abrasion CL | 293 / 11.53 | 143 / 5.62 | 48 / 1.89 | 137 / 5.39 | 16 / 35 |
| V43SYL | General Purpose Long CL | 286 / 11.25 | 127 / 5.00 | 24 / 0.95 | 137 / 5.39 | 13 / 29 |
| V43TVY | Twin Pick NCL | 327 / 12.88 | 143 / 5.62 | 18 / 0.71 | 137 / 5.39 | 13 / 29 |
| V43TVYH | Twin Pick Heavy NCL | 290 / 11.43 | 142 / 5.59 | 18 / 0.71 | 137 / 5.39 | 12 / 27 |
| V43TYL | General Purpose NCL | 286 / 11.25 | 140 / 5.50 | 18 / 0.69 | 137 / 5.39 | 14 / 30 |
| V43TYLCE | Non-Twist Long GP NCL | 286 / 11.25 | 140 / 5.50 | 18 / 0.69 | 137 / 5.39 | 14 / 30 |
| V43VY | Pick NCL | 327 / 12.88 | 16 / 0.62 | 18 / 0.71 | 137 / 5.39 | 11 / 24 |
| V43VYH | Pick Heavy NCL | 290 / 11.43 | 18 / 0.70 | 20 / 0.78 | 137 / 5.39 | 11 / 25 |

*CL: Centerline Design; NCL: Non-Centerline Design

Locking Pins

| PART ID | DESCRIPTION | L LENGTH mm/in | WEIGHT kg/lb |
|---------|----------------------|----------------------|-----------------|
| V43HPN | Super V Pin Hot Slag | 105 / 4.13 | .34 / .75 |
| V43PN | Super V Pin | 105 / 4.13 | .23 / .51 |

V43 Standard Pin

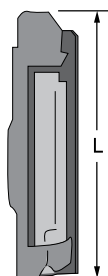

V43 Hot Slag Pin

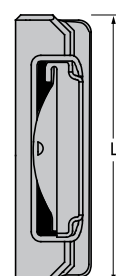

Pin Removal Tool

| PART ID | DESCRIPTION | WEIGHT kg/lb |
|-------------|------------------|-----------------|
| V39-V61RT-1 | Pin Removal Tool | 2.6 / 5.6 |

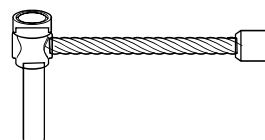

Type 1

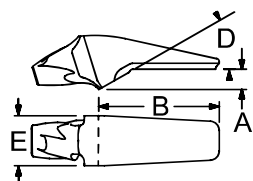

Type 4

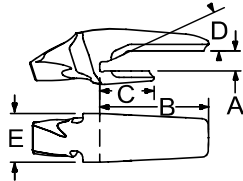

Type 5

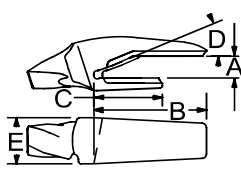

Type 8

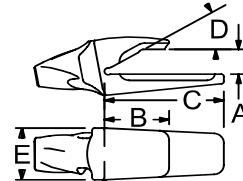

Weld-on Adapters

| PART ID | TYPE | DESCRIPTION | A LIP THICKNESS mm/in | B TOP LEG mm/in | C BOTTOM LEG mm/in | D RAMP ANGLE deg | E ADAPTER WIDTH mm/in | NOSE ANGLE deg | WEIGHT kg/lb | WEARCAP |
|---------------------|------|---------------------|--------------------------------|--------------------------|-----------------------------|---------------------------|--------------------------------|----------------------|-----------------|---------|
| Excavator | | | | | | | | | | |
| 5856-V43 | 8 | 1-1/2 Bottom Leg | 51 / 2.00 | 152 / 6.00 | 279 / 11.00 | 30 | 133 / 5.25 | 10 | 22 / 48 | N/A |
| 8801-V43 | 4 | 1-1/2 Top Leg | 51 / 2.00 | 267 / 10.50 | 146 / 5.75 | 30 | 133 / 5.25 | 10 | 22 / 48 | N/A |
| 3811-V43 | 4 | 1-1/2 Top Leg | 60 / 2.38 | 267 / 10.50 | 146 / 5.75 | 30 | 133 / 5.25 | 10 | 22 / 48 | N/A |
| Wheel Loader | | | | | | | | | | |
| 1810-V43 | 4 | 1-1/2 Top Leg | 51 / 2.00 | 279 / 11.00 | 175 / 6.88 | 22-25 | 133 / 5.25 | 17 | 26 / 57 | N/A |
| 1810R-V43 | 5 | 1-1/2 Top Leg Spade | 51 / 2.00 | 279 / 11.00 | 175 / 6.88 | 22-25 | 133 / 5.25 | 17 | 27 / 60 | N/A |
| 1810L-V43 | 5 | 1-1/2 Top Leg Spade | 51 / 2.00 | 279 / 11.00 | 175 / 6.88 | 22-25 | 133 / 5.25 | 17 | 27 / 60 | N/A |
| 3892-V43 | 1 | Flushmount | 51 / 2.00 | 321 / 12.64 | N/A | 22 | 133 / 5.25 | 17 | 25 / 55 | N/A |
| 5840L-V43 | 5 | 1-1/2 Top Leg Spade | 51 / 2.00 | 279 / 11.00 | 175 / 6.88 | 30 | 133 / 5.25 | 17 | 27 / 59 | N/A |
| 5840R-V43 | 5 | 1-1/2 Top Leg Spade | 51 / 2.00 | 279 / 11.00 | 175 / 6.88 | 30 | 133 / 5.25 | 17 | 27 / 59 | N/A |
| 1828LB-V43 | 5 | 1-1/2 Top Leg Spade | 64 / 2.50 | 267 / 10.50 | 133 / 5.25 | 30 | 133 / 5.25 | 17 | 24 / 53 | N/A |
| 1828RB-V43 | 5 | 1-1/2 Top Leg Spade | 64 / 2.50 | 267 / 10.50 | 133 / 5.25 | 30 | 133 / 5.25 | 17 | 24 / 52 | N/A |
| 1829B-V43 | 4 | 1-1/2 Top Leg | 64 / 2.50 | 267 / 10.50 | 133 / 5.25 | 30 | 133 / 5.25 | 17 | 23 / 51 | N/A |

Weld-on Nose

| PART ID | DESCRIPTION | A WIDTH mm/in | B HEIGHT mm/in | C J-GROOVE mm/in | WEIGHT kg/lb |
|---------|-------------|---------------------|----------------------|------------------------|-----------------|
| WN-V43 | Weldon Nose | 133 / 5.25 | 129 / 5.06 | 30 / 1.20 | 10 / 23 |

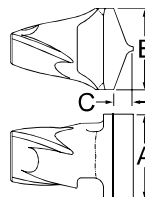

Type 31

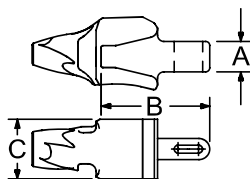

Horn Adapters

| PART ID | TYPE | DESCRIPTION | A SHANK HEIGHT mm/in | B SHANK LENGTH mm/in | C WIDTH mm/in | WEIGHT kg/lb | SPOOL ID | WEDGE ID* | LIP SERIES | MACHINE TYPE |
|----------|------|-------------|-------------------------------|-------------------------------|---------------------|-----------------|----------|--------------------|------------|--------------|
| 129A-V43 | 31 | Horn Style | 64 / 2.50 | 218 / 8.59 | 127 / 5.00 | 20 / 44 | 29SP | 29W1, 29W2 OR 29W3 | C29 | BACKHOE |

Type 28

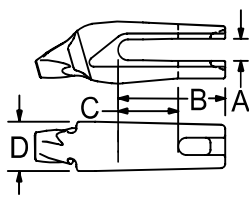

Type 29

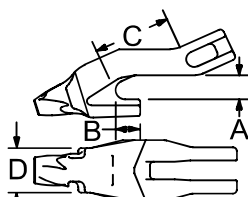

ZL Adapters

| PART ID | TYPE | DESCRIPTION | NOSE ANGLE deg | A LEG OPENING mm/in | B BOTTOM LEG mm/in | C WIDTH mm/in | D WEDGE SLOT mm/in | WEIGHT kg/lb | C-CLAMP ID | WEDGE ID | LIP SERIES |
|----------|------|-------------------------|----------------------|------------------------------|-----------------------------|---------------------|-----------------------------|-----------------|------------|----------|------------|
| 414B-V43 | 28 | Zipper Lip 2 Leg | 17 | 57 / 2.25 | 329 / 12.94 | 140 / 5.50 | 192 / 7.57 | 44 / 96 | R414CL | R414W | 50R, 126R |
| 415B-V43 | 29 | Zipper Lip 2 Leg Corner | 17 | 57 / 2.25 | 77 / 3.02 | 140 / 5.50 | 259 / 10.20 | 46 / 102 | R414CL | R414W | 50R, 126R |